

Warman High School – 2025-2026

Stop #	Bus Color	Route #	Departure	Drop off	Stop location
7	Gold	WR-11	8:25 am	3:42 pm	<ul style="list-style-type: none"> Crystal Springs Lake (greenspace)
16	White	WR-08	8:22 am	3:35 pm	<ul style="list-style-type: none"> 1st Avenue & Diamond Street (greenspace)
21	Light Pink	WR-06	8:25 am	3:42 pm	<ul style="list-style-type: none"> Pebble Beach Boulevard & St. Andrew's Lane (Larry Nelson Park)
22	Lime	WR-13	8:30 am	3:36 pm	<ul style="list-style-type: none"> Crystal Springs Drive & Braun Lane (Neil Wagner Park)
24	Red	WR-09	8:26 am	3:40 pm	<ul style="list-style-type: none"> Crystal Springs Drive (west alley btw Brooklyn Court & Crescent)
25	White	WR-08	8:30 am	3:40 pm	<ul style="list-style-type: none"> Industrial Road & Haichert St intersection (mailboxes)
40	Dark Green	WR-16	8:28 am	3:40 pm	<ul style="list-style-type: none"> Glen Abby Boulevard (mailboxes btw Scott & Wier Crescent)

Students are to be at the stop 5 minutes before departure time.

Things to know:

- Times fluctuate for various reasons; therefore, please revisit the website periodically for updates.
- Visit our website, www.spiritsd.ca/buses/ to see daily alerts for each bus route.
- Bus passes will be distributed from the students by the school's, 24-72 hours after the request has been processed.
- Bus requests are to be submitted directly online at www.spiritsd.ca and have a 7-business day processing time throughout the year; however, requests submitted in August and September may be longer.

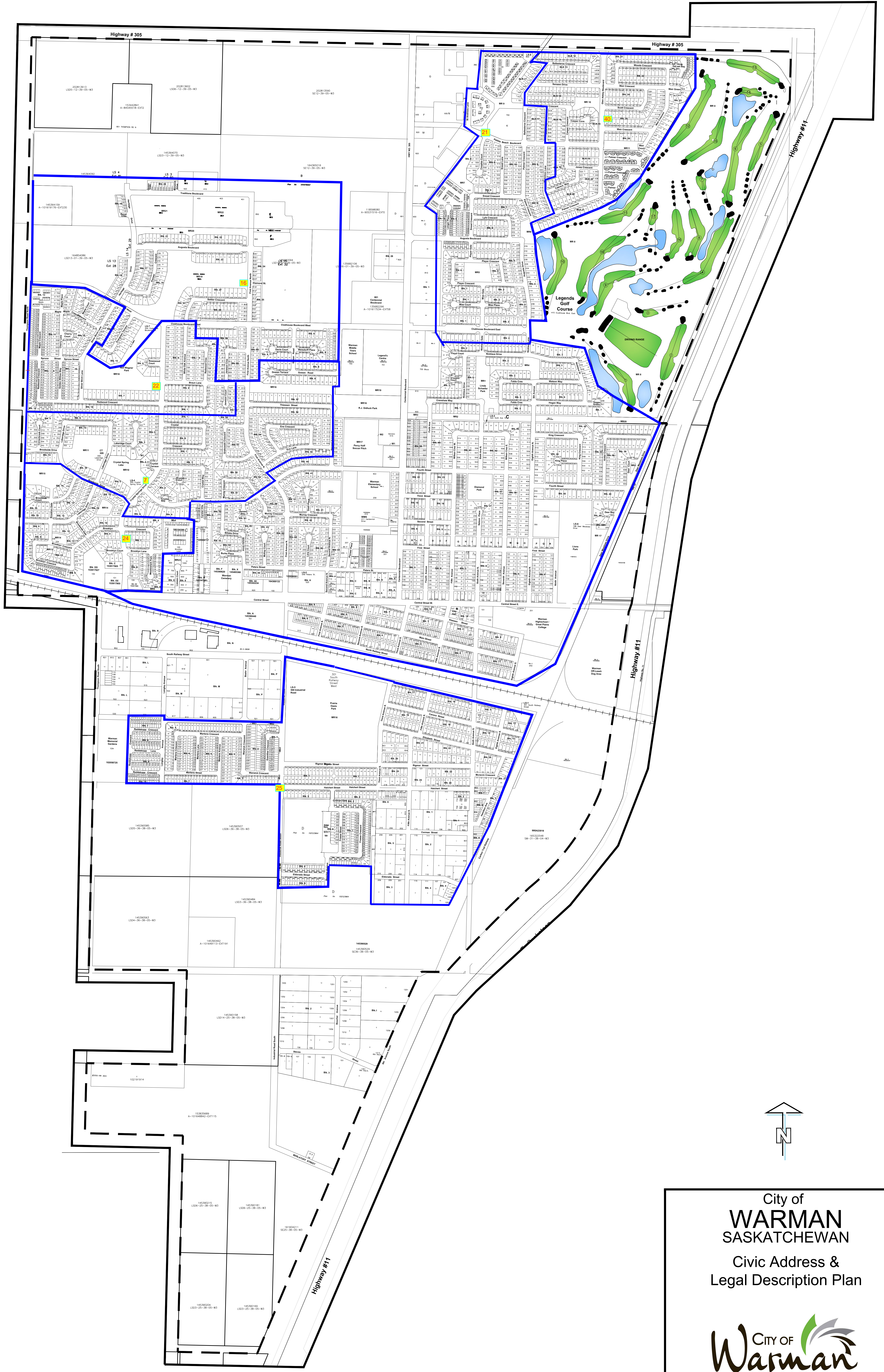

City of
WARMAN
 SASKATCHEWAN
 Civic Address &
 Legal Description Plan

