

## École Warman Elementary School – 2025-2026

Stop #	Bus Color	Route #	Departure	Drop Off	Stop location
1	Gold	WR-11	8:03 am	2:52 pm	• Rigmor Street (across from 120)
2	Gold	WR-11	8:07 am	2:56 pm	• 5 <sup>th</sup> Avenue South (eastside – btw Canora St & South Railway St. W)
3	Gold	WR-11	8:05 am	2:54pm	• 6 <sup>th</sup> Avenue South & Elizabeth Street East (across from 102)
4	Dark Green	WR-16	8:05 am	3:00 pm	• Crystal Springs Drive (East alley between Brooklyn Lane & Crescent)
5	Brown	WR-15	8:00 am	3:00 pm	• Ballesteros Crescent & Casper Crescent intersection (mailboxes)
6	Grey	WR-10	7:58 am	2:57 pm	• Brookside Drive (across 206)
7	Dark Green	WR-16	8:12 am	3:05 pm	• Crystal Springs Lake greenspace
8	Dark Green	WR-16	8:00 am	2:55 pm	• 4 <sup>th</sup> Street East (across from 433) between Antler Cres & Deer Court
9	Brown	WR-15	7:55 am	2:56 pm	• Mickelson Lane (across from 505)
10	Grey	WR-10	8:07 am	3:04 pm	• Braun Lane (alley between White Oak & Redwood Crescent)
11	Lime	WR-13	8:11 am	3:06 pm	• 8 <sup>th</sup> Avenue & 1 <sup>st</sup> Street intersection (across from 4-plexes)
12	Orange	WR-05	8:09 am	2:52 pm	• 5 <sup>th</sup> Avenue & Main Street Intersection (across from Awakening Church)
13	Orange	WR-05	8:02 am	2:54 pm	• Warwick Crescent (across from 117)
14	Lime	WR-13	8:07am	2:55 pm	• Player Crescent & Mize Gate (Rick Unger Park)
15	Lime	WR-13	8:09 am	2:59 pm	• 8 <sup>th</sup> Avenue North & Watson Way (Linda Schaefer Park)
16	Dark Green	WR-16	8:09 am	3:08 pm	• 1 <sup>st</sup> Avenue & Diamond Street (greenspace)
17	Grey	WR-10	8:03 pm	3:01 pm	• Silver Birch Lane greenspace (across from 503)
18	Lime	WR-13	8:05 am	2:52pm	• Snead Crescent walking path (between 428 & 430)
19	Gold	WR-11	8:11 am	3:05 pm	• Brooklyn Crescent greenspace between 334 & 332
21	Brown	WR-15	7:44 am	3:15 pm	• Steves St **Temporary location
23	Orange	WR-05	8:06 am	2:57 pm	• Martens Street (across 423) between Martens Cres & Martens Lane
40	Brown	WR-15	7:58 am	2:58 pm	• Glen Abby Boulevard (mailboxes btw Scott & Wier Crescent)

**Students are to be at the stop 5 minutes before departure time.**

### Things to know:

- Times fluctuate for various reasons; therefore, please revisit the website periodically for updates.
- Visit our website, [www.spiritsd.ca/buses/](http://www.spiritsd.ca/buses/) to see daily alerts for each bus route.
- Bus passes will be distributed from the students by the school's, 24-72 hours after the request has been processed.
- Bus requests are to be submitted directly online at [www.spiritsd.ca](http://www.spiritsd.ca) and have a 7-business day processing time throughout the year; however, requests submitted in August and September may be longer

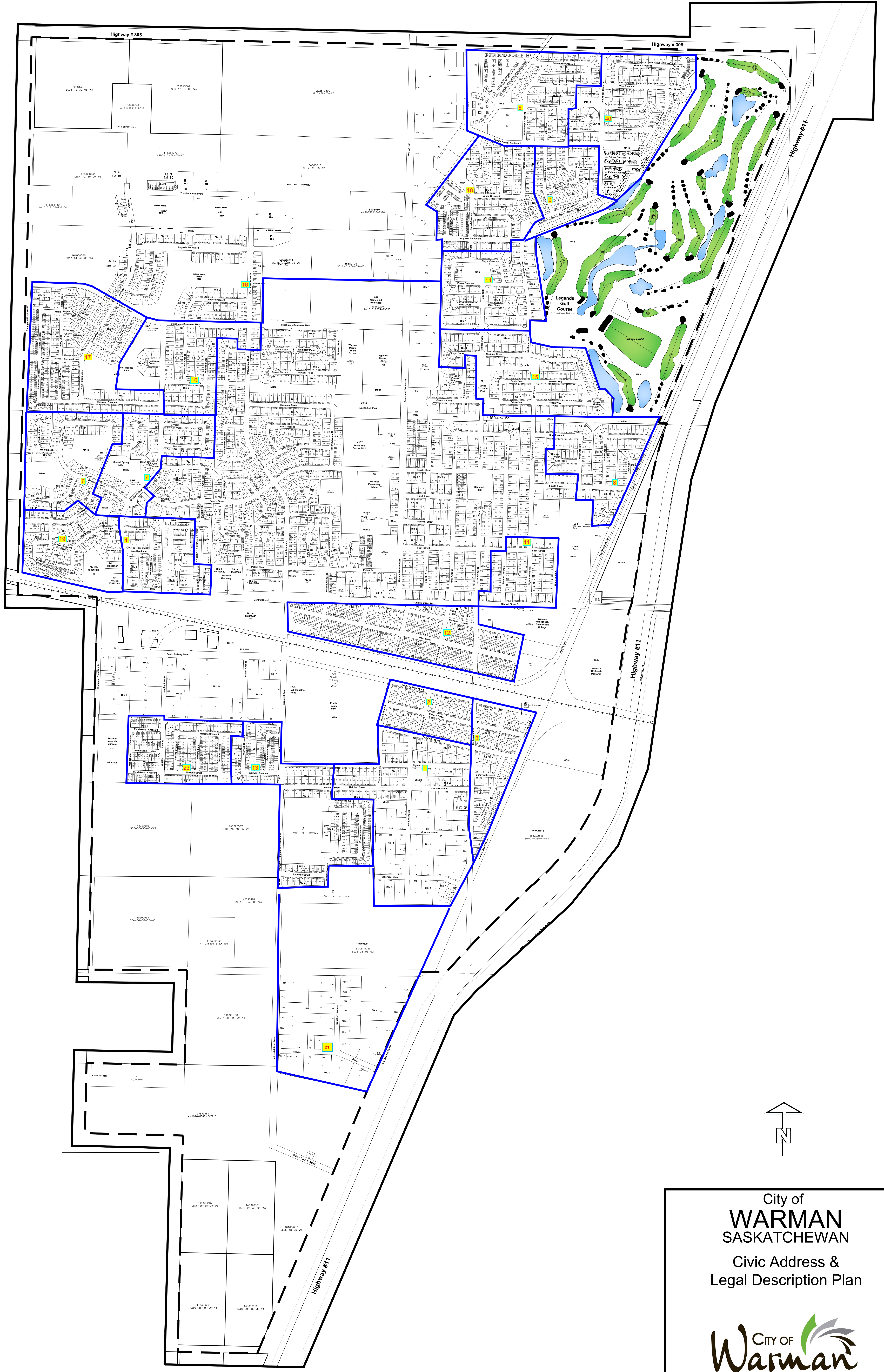

City of  
**WARMAN**  
 SASKATCHEWAN  
 Civic Address &  
 Legal Description Plan

